

Photointerrupter

Model No: LBT-134

Features

- High sensing accuracy (Slit width: 0.5mm)
- PWB direct mounting type package

Applications

- Copiers, printers, facsimiles
- Optoelectronic switches

Outline Dimensions

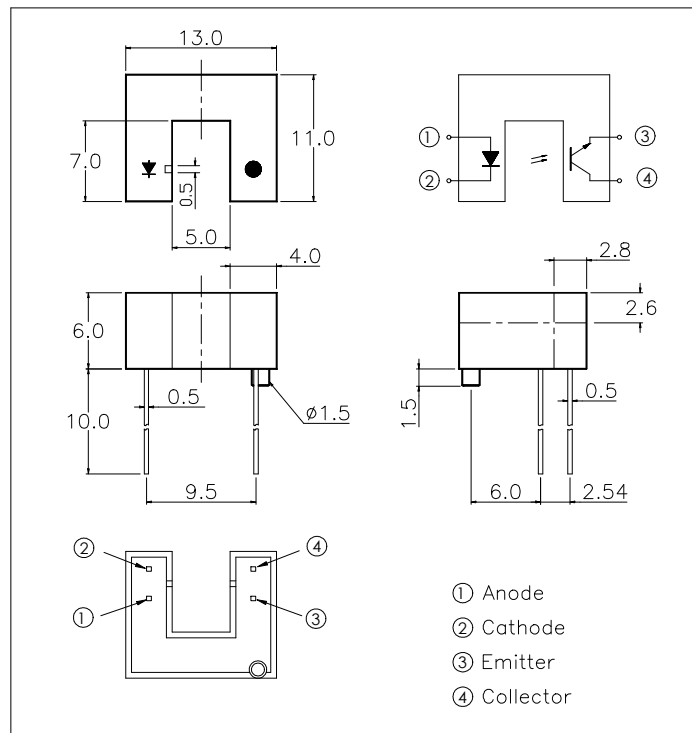

Notes: All dimensions are in millimeter
Tolerances is ± 0.25

Photointerrupter

Model No: LBT-134

Absolute Maximum Ratings (Ambient Temperature: 25°C)

Item		Symbol	Rating	Units	Note
Input	Forward current	I _F	50	mA	
	Reverse voltage	V _R	5	V	
	Peak forward current	I _{FP}	1	A	T _w =10 μs, t=10ms
	Power dissipation	P _d	75	mW	
Output	Collector current	I _c	50	mA	
	Collector-Emitter voltage	V _{ceo}	30	V	
	Emitter-Collector voltage	V _{eco}	5	V	
	Collector power dissipation	P _c	100	mW	
Storage Temperature		T _{stg}	-40 to +85	°C	
Operating Temperature		T _{op}	-25 to +85	°C	
Soldering Temperature		T _{sol}	260	°C	5 seconds max.

Electrical Specifications (Ambient Temperature: 25°C)

Item		Symbol	MIN.	TYP.	MAX.	Units	Conditions
Input	Forward voltage	V _F	1.0	1.15	1.3	V	I _F =20mA
	Reverse current	I _R			10	μA	V _R =5V
	Peak wavelength	λ _p		940		nm	
	View angle	2θ 1/2		35		Deg.	I _F =20mA
Output	Dark current	I _{ceo}			100	nA	V _{ce} =20V
	C-E saturation voltage	V _{ce(sat)}		0.15	0.4	V	I _c =2mA, I _B =0.1mA
Light current		I _{c(on)}	0.5	2.0		mA	V _{ce} =5V I _F =20mA
Leakage current		I _{Leak}			1	μA	
Speed	Rise Time	t _r		30		μs	V _{ce} =5V I _c =1mA R _L =1KΩ
	Fall Time	t _f		25			

Photointerrupter Reference Data

